

Dealer: SWAS

Approved By:

Date:

Customer:

COMAL

22-171-060-61

Sheet  
**A**

ALL WARNING, SCENE, AND TAIL LIGHTS TO HAVE CHROME BEZELS.  
ALL COMPARTMENT/ENTRY DOORS TO HAVE POWER LOCKS  
WIRE TO OEM

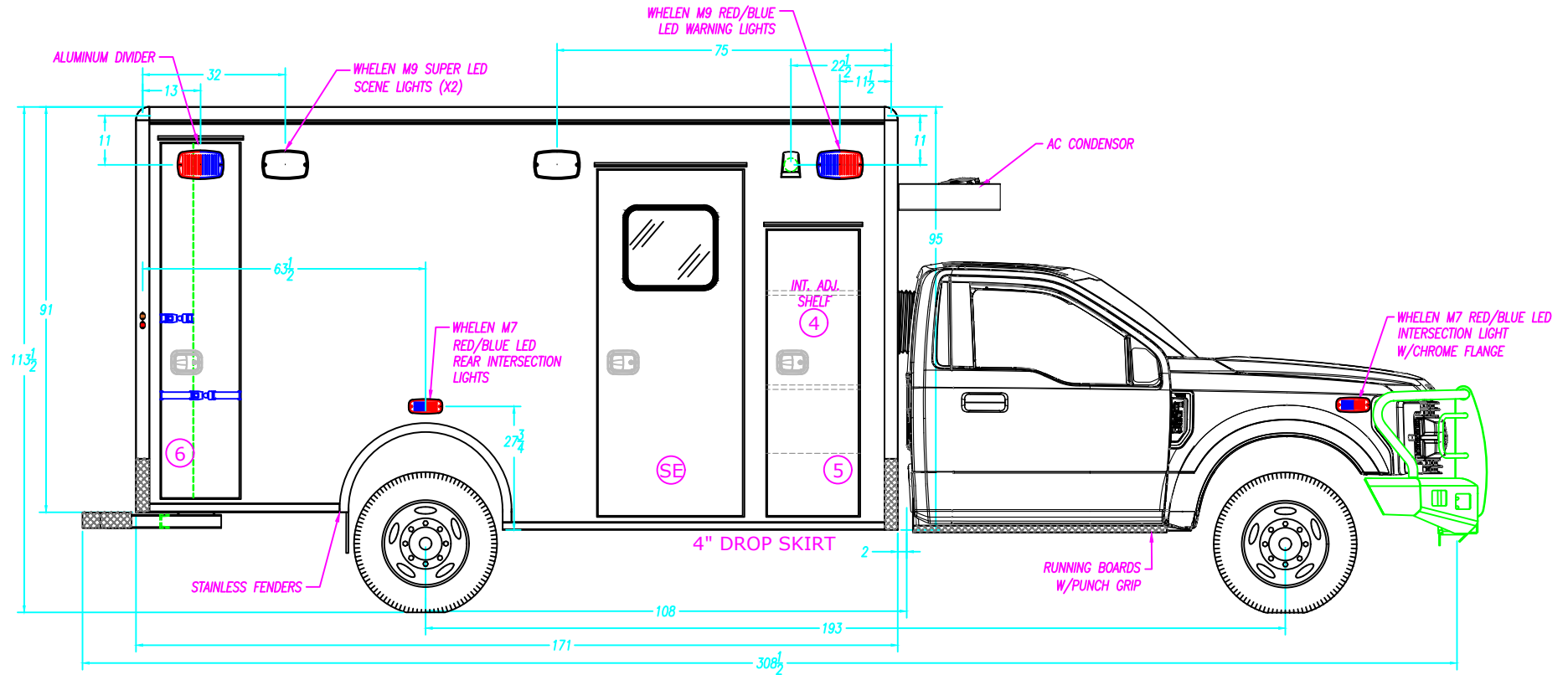

**COMPARTMENT SIZES**

NOTE: THE DIMENSIONS BELOW ARE INSIDE TUB DIMENSIONS

NO.	COMPARTMENT TYPE	WIDTH	HEIGHT	DEPTH
4	ALS COMPARTMENT	---	---	---
5	BATTERY COMPARTMENT	20 1/2"	18 1/2"	22 3/8"
6	BACK BOARD COMPARTMENT	20"	79 1/2"	21 1/2"

**COMPARTMENT & ENTRY DOORS**

NO.	DOOR NUMBER	NO.	LINER NUMBER
4-5	78-113845	4-5	-
6	78-113846	6	-
SE	78-116138	SE	-

**COMPARTMENT TUBS**

NO.	PART NUMBER	NO.	PART NUMBER
4	77-113774	-	---
6	77-114166	-	---
ENT.	33-102648	-	---

**COMPARTMENT / ENTRY DOOR SIZES**

NO.	COMPARTMENT / ENTRY DOOR TYPE	WIDTH	HEIGHT
4	ALS DOOR	20 1/2"	64 1/16"
5	BATTERY STORAGE DOOR	---	---
SE	SIDE ENTRY DOOR	32 1/2"	77 3/16"
6	BACK BOARD STORAGE DOOR	17 1/2"	79 3/16"

AL-171" TYPE I  
FORD F-450/550-DIESEL-193" W.B.

DESCRIPTION: CURB SIDE EXTERIOR

DRAWN BY: I.STANSBURY	DATE CREATED: 4/17/2023	SCALE: 5/16"=1'
REVISED BY: I.STANSBURY	DATE REVISED: 4/25/2023	REVISION: C

Note: Drawings are for reference only, measurements may vary from actual product.



**MEDIX** 3008 MOBILE DRIVE  
ELKHART, IN 46514  
PH: 574-266-0911  
SPECIALTY VEHICLES, INC. FAX: 574-266-6669

"LET US SHOW YOU THE MEDIX DIFFERENCE"  
WWW.MEDIXAMBULANCE.COM

Dealer: SWAS

Approved By:

Date:

Customer:

COMAL

22-171-060-61

Sheet  
**B**

ALL WARNING, SCENE, AND TAIL LIGHTS TO HAVE CHROME BEZELS.  
ALL COMPARTMENT/ENTRY DOORS TO HAVE POWER LOCKS  
WIRE TO OEM

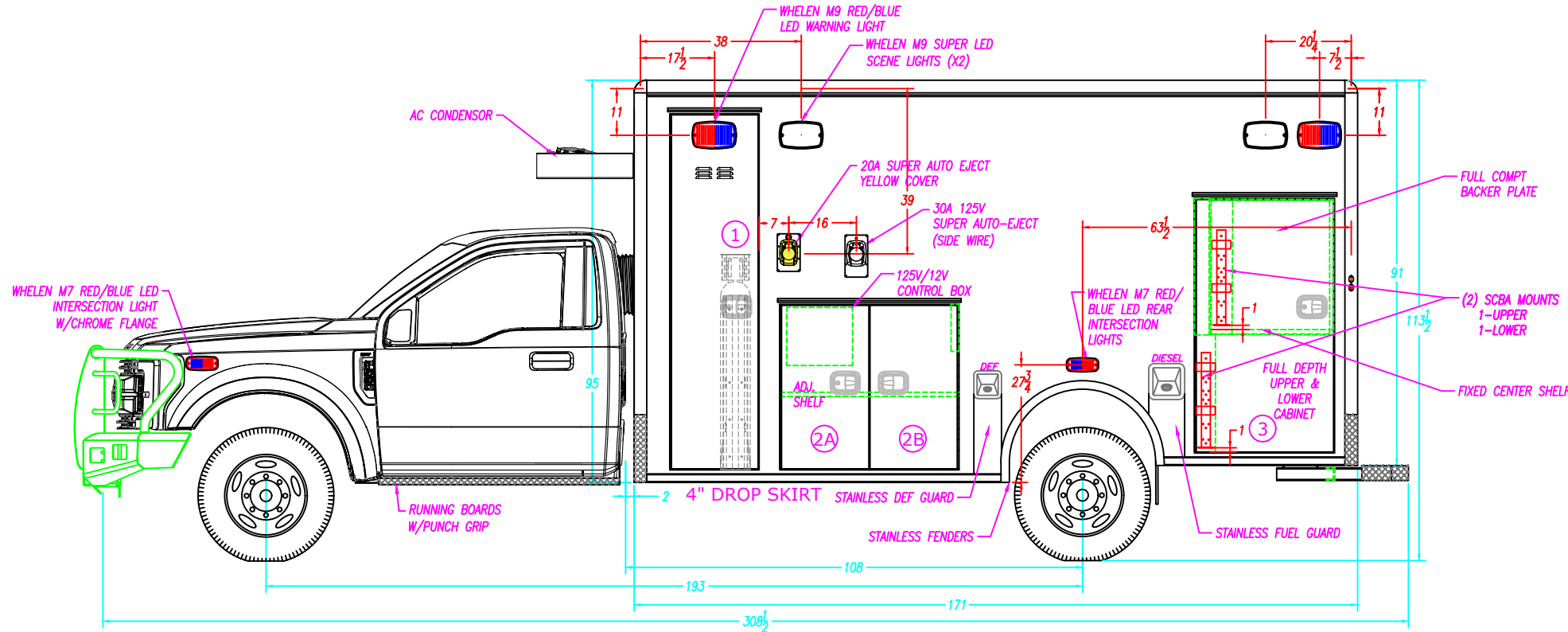

COMPARTMENT SIZES		NOTE: THE DIMENSIONS BELOW ARE INSIDE TUB DIMENSIONS		
NO.	COMPARTMENT TYPE	WIDTH	HEIGHT	DEPTH
1A	ELEC COMPARTMENT	20 1/2"	23 1/2"	18"
1B	O2 COMPARTMENT	20 1/2"	59 1/2"	18"
2	MID STORAGE COMPARTMENT	41 3/4"	38 1/2"	18"
3	REAR STORAGE COMPARTMENT	34"	59 1/2"	18 1/2"

COMPARTMENT & ENTRY DOORS			
NO.	DOOR NUMBER	NO.	LINER NUMBER
1	78-113838	1	-
2A	78-113840-2	2A	-
2B	78-113840-3	2B	-
3	78-113844	3	-

COMPARTMENT TUBS			
NO.	PART NUMBER	NO.	PARTNUMBER
1	77-113769	-	---
2	77-117787	-	---
3	77-116287	-	---

COMPARTMENT / ENTRY DOOR SIZES			
NO.	COMPARTMENT / ENTRY DOOR TYPE	WIDTH	HEIGHT
1A	ELEC STORAGE DOOR	20 1/2"	23 5/8"
1B	O2 STORAGE DOOR	20 1/2"	59 3/8"
2A	MID STORAGE DOOR-A	20 1/16"	38 3/16"
2B	MID STORAGE DOOR-B	20 1/16"	38 3/16"
3	REAR STORAGE DOOR	30 1/16"	59 3/16"

AL-171" TYPE I  
FORD F-450/550-DIESEL-193" W.B.

DESCRIPTION: STREET SIDE EXTERIOR

DRAWN BY: I.STANSBURY	DATE CREATED: 4/17/2023	SCALE: 5/16"=1'
REVISED BY: I.STANSBURY	DATE REVISED: 4/25/2023	REVISION: C

Note: Drawings are for reference only, measurements may vary from actual product.



3008 MOBILE DRIVE  
ELKHART, IN 46514  
PH: 574-266-0911  
FAX: 574-266-6669

SPECIALTY VEHICLES, INC.

"LET US SHOW YOU THE MEDIX DIFFERENCE"  
WWW.MEDIXAMBULANCE.COM

Dealer: SWAS

Approved By:

Date:

Customer: COMAL

COMAL

22-171-060-61

Sheet  
**C**

ALL WARNING, SCENE, AND TAIL LIGHTS TO HAVE CHROME BEZELS.  
ALL COMPARTMENT/ENTRY DOORS TO HAVE POWER LOCKS  
WIRE TO OEM

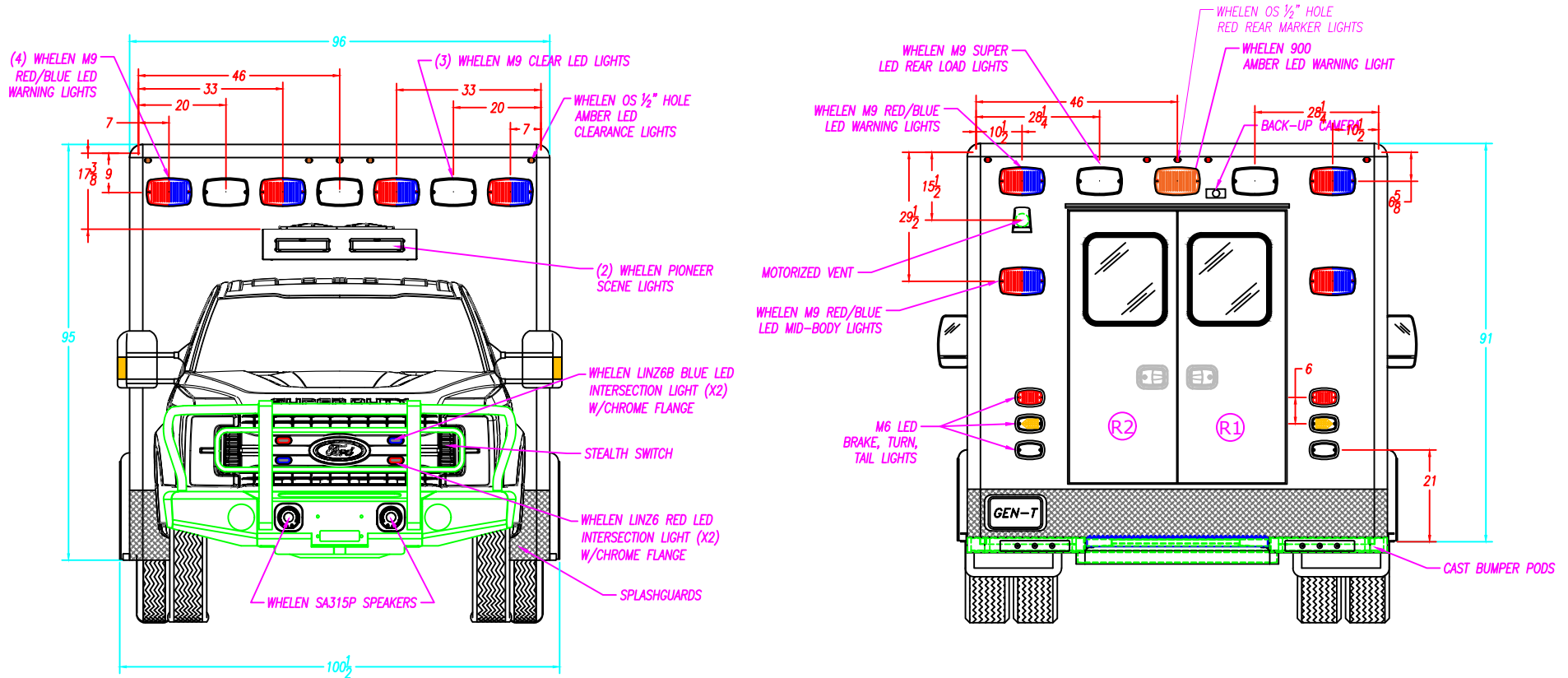

REAR ENTRY DOOR SIZES

NO.	WIDTH	HEIGHT	PART NUMBER
R1	24 5/16"	62"	78-116140-2
R2	24 5/16"	62"	78-116140-3

AL-171" TYPE I FORD F-450/550-DIESEL-193" W.B.		
DESCRIPTION: FRONT & REAR EXTERIOR		
DRAWN BY: I.STANSBURY	DATE CREATED: 4/17/2023	SCALE: 5/16"=1'
REVISED BY: I.STANSBURY	DATE REVISED: 4/25/2023	REVISION: C
Note: Drawings are for reference only, measurements may vary from actual product.		

**MEDIX** 3008 MOBILE DRIVE  
ELKHART, IN 46514  
PH: 574-266-0911  
SPECIALTY VEHICLES, INC. FAX: 574-266-6669

"LET US SHOW YOU THE MEDIX DIFFERENCE"  
WWW.MEDIXAMBULANCE.COM

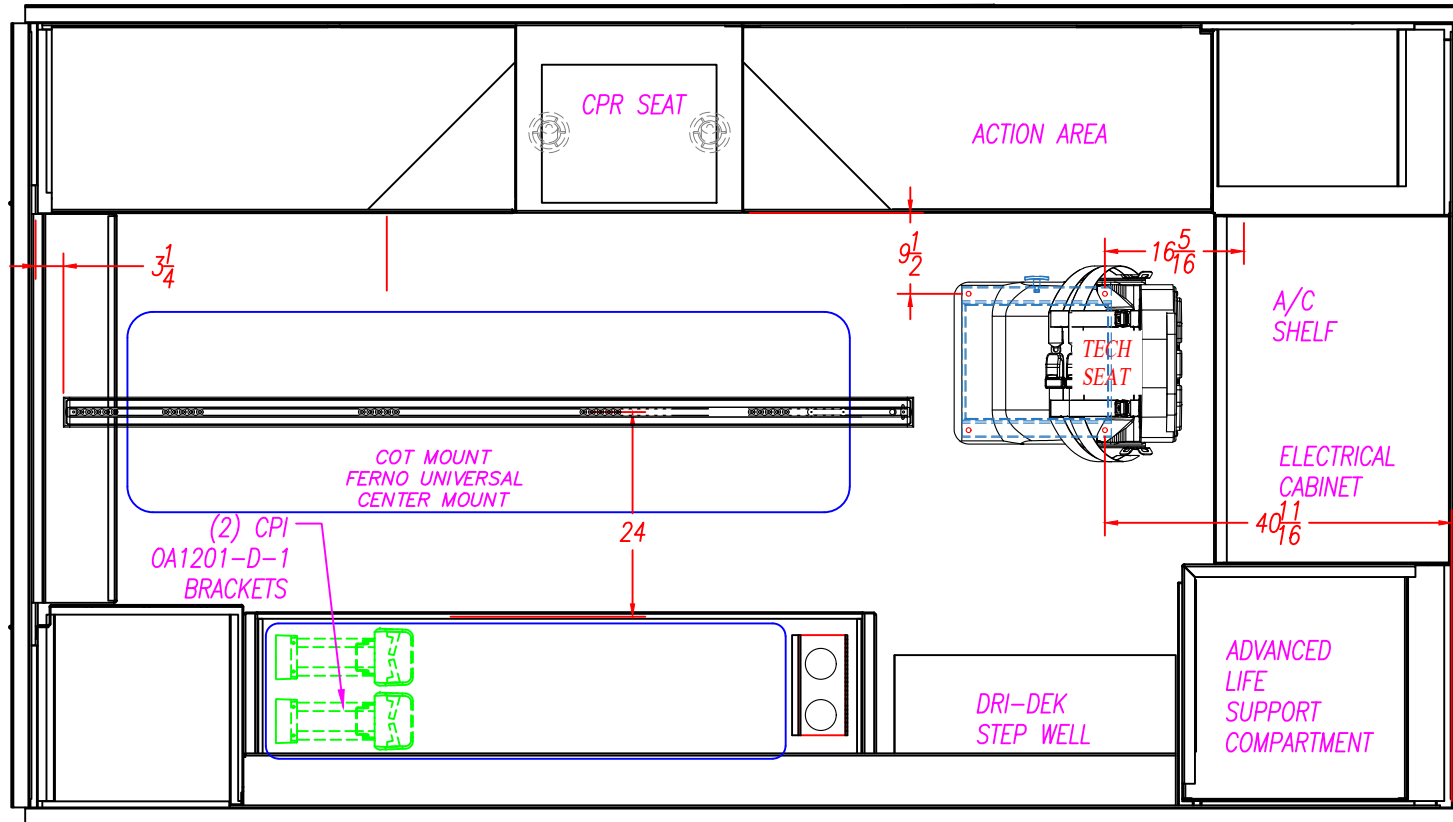

AL-171" TYPE I  
 FORD F-450/550-DIESEL-193" W.B.

DESCRIPTION:  
 PATIENT AREA PLAN

DRAWN BY: I.STANSBURY	DATE CREATED: 4/17/2023	SCALE: 1/2"=1'
REVISED BY: I.STANSBURY	DATE REVISED: 4/25/2023	REVISION: C

Note: Drawings are for reference only, measurements may vary from actual product.



**MEDIX**  
 SPECIALTY VEHICLES, INC.

3008 MOBILE DRIVE  
 ELKHART, IN 46514  
 PH: 574-266-0911  
 FAX: 574-266-6669

"LET US SHOW YOU THE MEDIX DIFFERENCE"  
 WWW.MEDIXAMBULANCE.COM

CORIAN COUNTERTOPS IN 1ST & 2ND ACTION AREA.

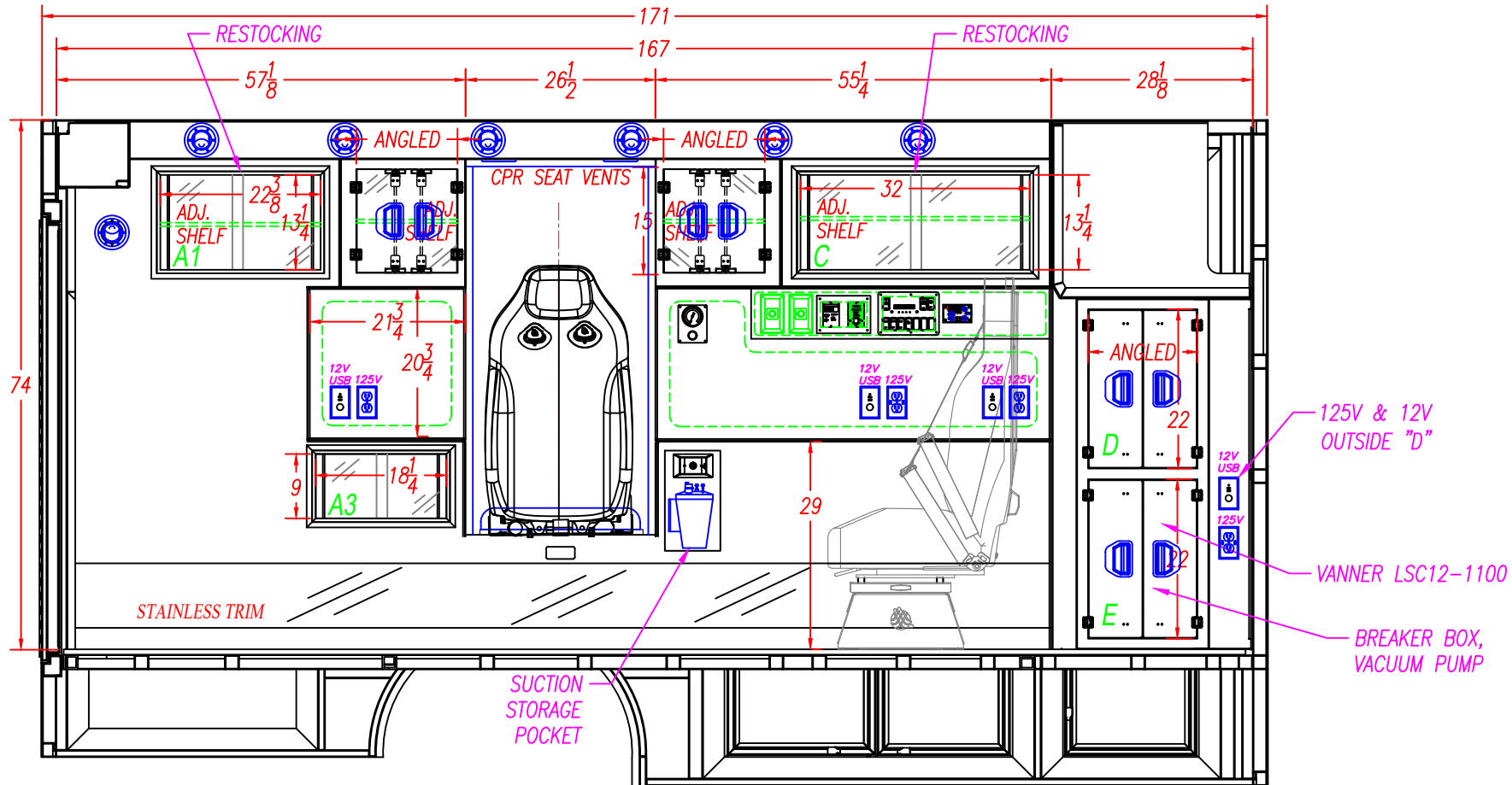

INTERIOR CABINET STORAGE

ITEM	HEIGHT	WIDTH	DEPTH	PART #'S
A1	16 1/2"	21 7/8"	17 1/2"	-
A2	10 3/8"	18"	19 1/8"	-
C	16 1/2"	33 1/2"	17 3/8"	-
D	16 7/8"	17 5/8"	16 3/4"	-
E	16 7/8"	17 3/8"	16 3/4"	-

AL-171" TYPE I		
FORD F-450/550-DIESEL-193" W.B.		
DESCRIPTION: STREET SIDE INTERIOR		
DRAWN BY: I.STANSBURY	DATE CREATED: 4/17/2023	SCALE: 1/2"=1'
REVISED BY: I.STANSBURY	DATE REVISED: 4/25/2023	REVISION: C

Note: Drawings are for reference only, measurements may vary from actual product.

**MEDIX** 3008 MOBILE DRIVE  
ELKHART, IN 46514  
PH: 574-266-0911  
SPECIALTY VEHICLES, INC. FAX: 574-266-6669  
"LET US SHOW YOU THE MEDIX DIFFERENCE"  
WWW.MEDIXAMBULANCE.COM

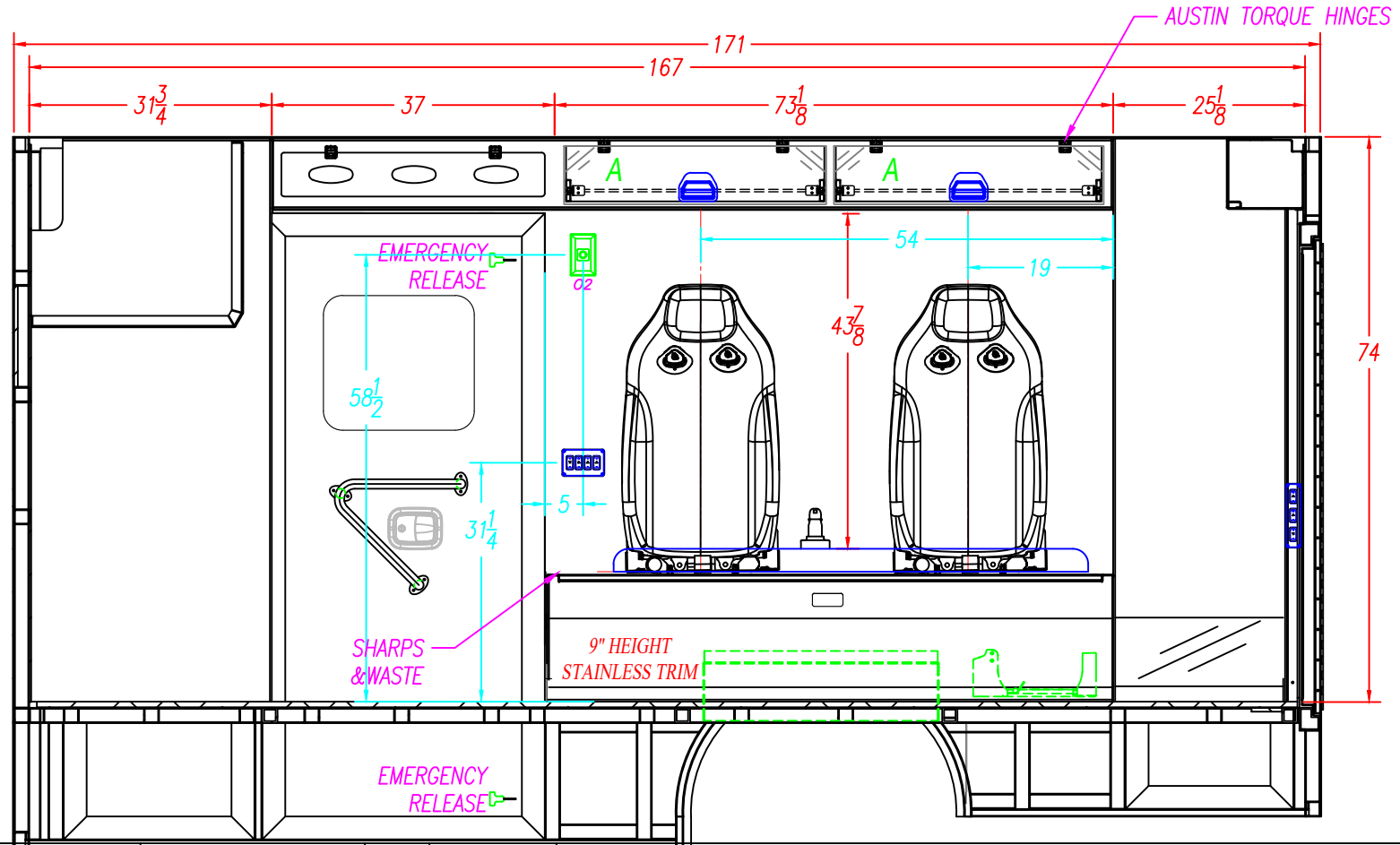

### 4" SEATBELT PLATE LOCATION

<b>WELD SHOP</b>	33	<b>INCHES</b>	NOTE: THIS DIMENSION IS FROM THE BOTTOM OF THE WALL TO THE BOTTOM OF THE 4" PLATE.
<b>CABINET SHOP</b>	NOTE: THE HOLES FOR THE TOP SEATBELT BOLTS ARE 1 1/4" FROM THE TOP OF THE SQUAD BENCH TO THE CENTER OF THE SEATBELT BOLT. NOTE: THE HOLES FOR THE BOTTOM SEATBELT BOLTS ON THE SQUAD BENCH ARE 9 3/8" FROM THE TOP OF THE FLOOR TO THE CENTER OF THE BOLT.		
NOTE: READ THE DIMENSIONS FROM RIGHT TO LEFT AS VIEWED	THE LOCATION OF THE BOTTOM SEATBELT HOLES ARE FROM THE REAR OF THE SQUAD BENCH TO THE CENTER OF THE 1/2" HOLE	<b>BOTTOM</b>	
	THE LOCATION OF THE TOP SEATBELT HOLES ARE FROM THE REAR WALL TO THE CENTER OF THE 1/2" HOLE	<b>TOP</b>	

INTERIOR CABINET STORAGE				
ITEM	HEIGHT	WIDTH	DEPTH	SPECIAL NOTE
A	6 3/4"	34 1/4"	5 7/8"	
B				
C				
D				
E				
F				

AL-171" TYPE I FORD F-450/550-DIESEL-193" W.B.		
DESCRIPTION: CURB SIDE INTERIOR		
DRAWN BY: I. STANSBURY	DATE CREATED: 4/17/2023	SCALE: 1/2"=1'
REVISED BY: I. STANSBURY	DATE REVISED: 4/25/2023	REVISION: C
Note: Drawings are for reference only, measurements may vary from actual product.		

3008 MOBILE DRIVE  
ELKHART, IN 46514  
PH: 574-266-0911  
FAX: 574-266-6669

**"LET US SHOW YOU THE MEDIX DIFFERENCE"**  
WWW.MEDIXAMBULANCE.COM

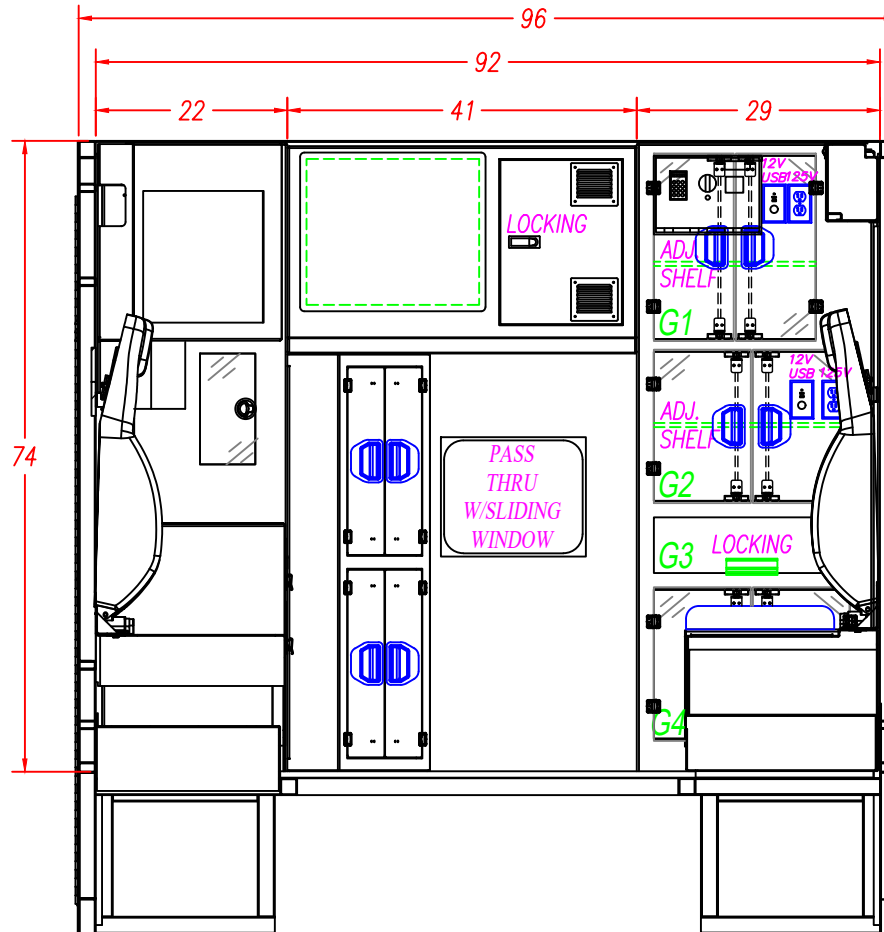

MEDVAULT 2

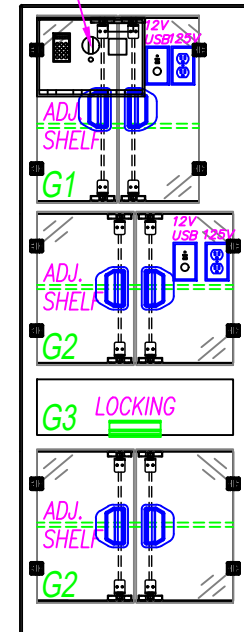

INTERIOR CABINET STORAGE

ITEM	HEIGHT	WIDTH	DEPTH	PART #'S
G1	21 1/2"	18"	27"	-
G2	17 7/8"	23"	27"	-
G3	6 1/2"	23"	18"	-
G4	17 7/8"	23"	27"	-

AL-171" TYPE I  
FORD F-450/550-DIESEL-193" W.B.

DESCRIPTION: FRONT ELEVATION		
DRAWN BY: I.STANSBURY	DATE CREATED: 4/17/2023	SCALE: 1/2"=1'
REVISED BY: I.STANSBURY	DATE REVISED: 4/25/2023	REVISION: C

Note: Drawings are for reference only, measurements may vary from actual product.

**MEDIX**  
SPECIALTY VEHICLES, INC.

3008 MOBILE DRIVE  
ELKHART, IN 46514  
PH: 574-266-0911  
FAX: 574-266-6669

"LET US SHOW YOU THE MEDIX DIFFERENCE"  
WWW.MEDIXAMBULANCE.COM

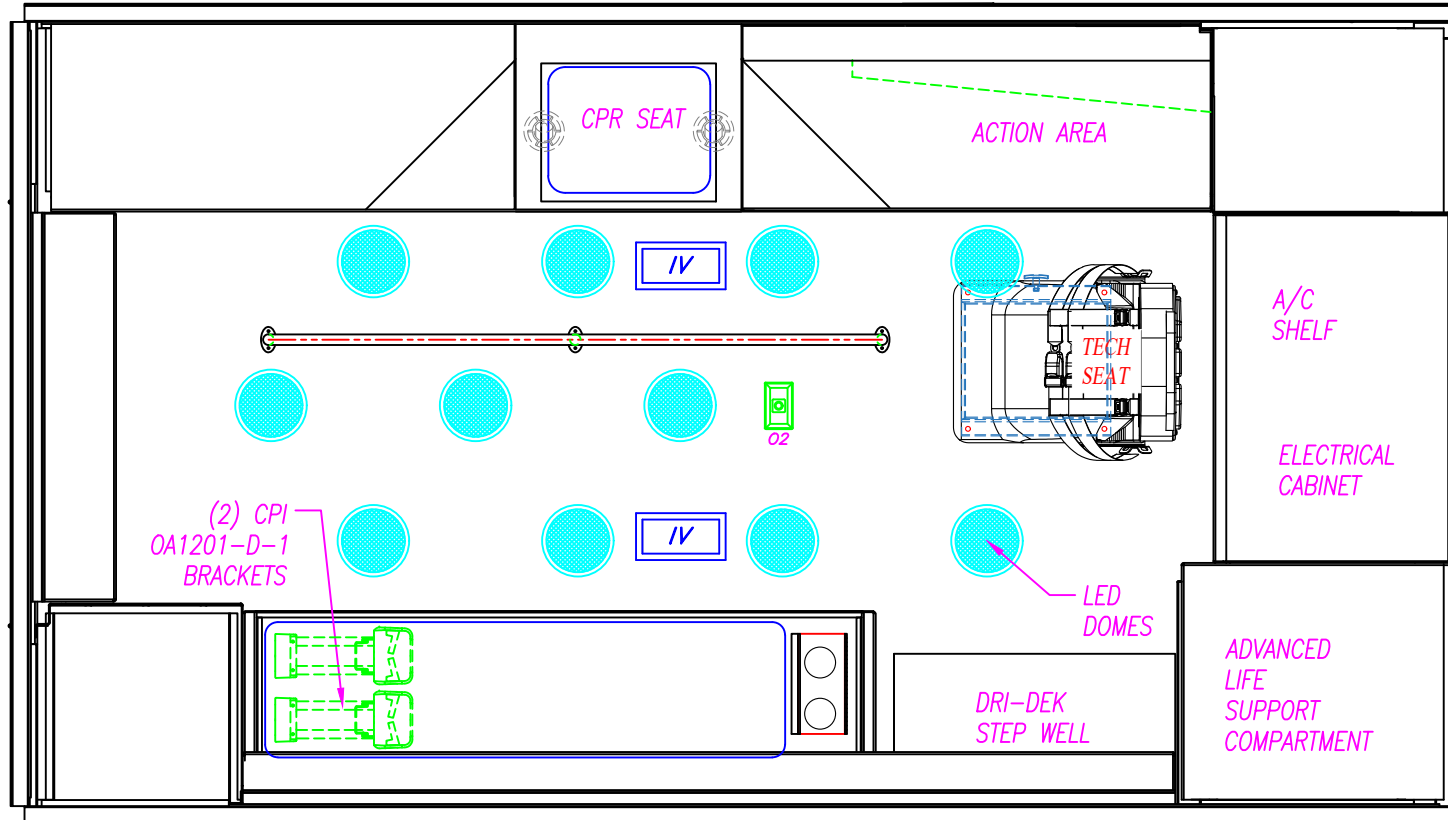

AL-171" TYPE I  
 FORD F-450/550-DIESEL-193" W.B.

DESCRIPTION: CEILING LAYOUT

DRAWN BY: I.STANSBURY	DATE CREATED: 4/17/2023	SCALE: 1/2"=1'
--------------------------	----------------------------	-------------------

REVISED BY: I.STANSBURY	DATE REVISED: 4/25/2023	REVISION: C
----------------------------	----------------------------	----------------

Note: Drawings are for reference only, measurements may vary from actual product.

**MEDIX** 3008 MOBILE DRIVE  
 ELKHART, IN 46514  
 PH: 574-266-0911  
 SPECIALTY VEHICLES, INC. FAX: 574-266-6669

"LET US SHOW YOU THE MEDIX DIFFERENCE"  
 WWW.MEDIXAMBULANCE.COM



Dealer: SWAS

Approved By:

Date:

Customer:

COMAL

22-171-060-61

Sheet

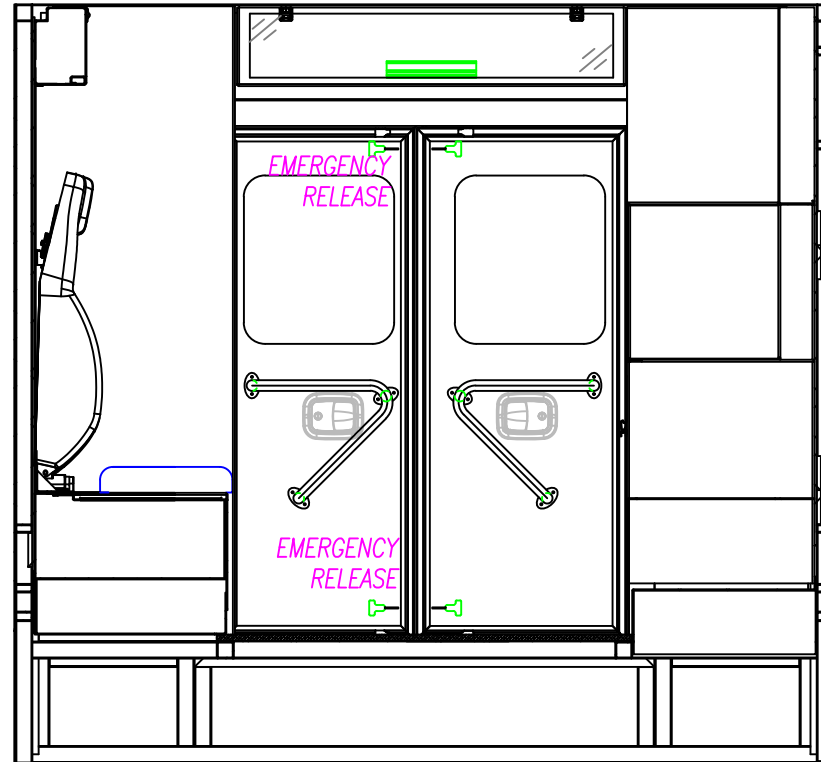

INTERIOR CABINET STORAGE

ITEM	HEIGHT	WIDTH	DEPTH	SPECIAL NOTE
A	6 7/8"	43"	8 1/8"	
B				
C				
D				
E				
F				

AL-171" TYPE I FORD F-450/550-DIESEL-193" W.B.		
DESCRIPTION: REAR ELEVATION		
DRAWN BY: I.STANSBURY	DATE CREATED: 4/17/2023	SCALE: 1/2"=1'
REVISED BY: I.STANSBURY	DATE REVISED: 4/25/2023	REVISION: C
Note: Drawings are for reference only, measurements may vary from actual product.		



**MEDIX**  
SPECIALTY VEHICLES, INC.

3008 MOBILE DRIVE  
ELKHART, IN 46514  
PH: 574-266-0911  
FAX: 574-266-6669

"LET US SHOW YOU THE MEDIX DIFFERENCE"  
WWW.MEDIXAMBULANCE.COM